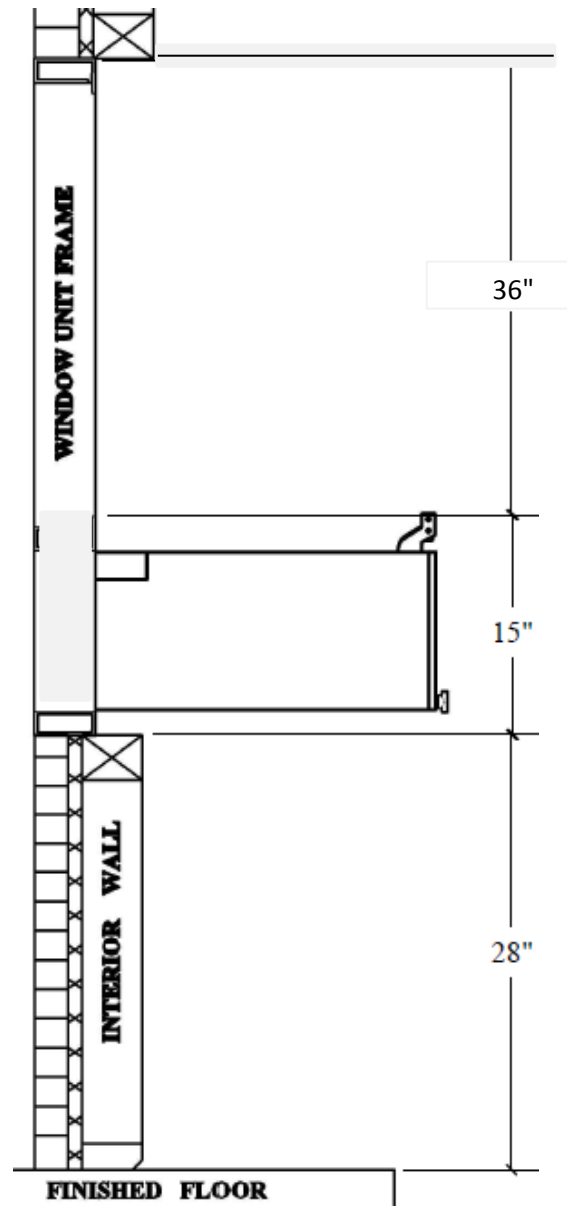

FIGURE 1

CAUTION:
Use caution when anchoring any other way. All Thread Rods are located in each side jamb. (See DETAIL A)

ANCHOR SCHEDULE		
SUBSTRATE	ANCHOR	MINIUM PENETRATION INTO SUBSTRATE
STEEL (16 GA. MIN.)	1/4" SHEET METAL SCREWS	MIN. PROTRUSION OF 3 THREADS BEYOND FULL ENGAGEMENT
CONCRETE	1/4" DIAMETER CONCRETE SCREW	1.25" INTO CONCRETE
WOOD BUCK	# 14 WOOD SCREW	1.50" INTO WOOD (REQUIRES DOUBLE 2X BUCK)



General Notes

Actual Dimension
48"(W) x 51"(H)

Service Opening
20-1/4"(W) x 29"(H)

Rough Opening
48-1/2"(W) x 51-1/2"(H)

Transfer Area
13"(W) x 6-1/2"(H) x 19"(D)

TYPICAL BRDW1-4851 INSTALLATION

1. Quikserv windows must be installed level & square to work properly.
2. Anchor through each side jambs through the pre-drilled holes. (See FIGURE 1)
3. Recommended height from floor to the bottom of the Window Unit Assembly to be 28". (Check all local & city codes)
4. All other type of anchoring to be approved by certified engineer

QUIKSERV
11441 BRITTMOORE PARK DR.
HOUSTON, TX., 77041

TITLE: BRDW1-4851 with QSP-713S DRAWER

Drawing Name: BRDW1-4851 INSTALLATION DRAWING

DATE 6/23/2016	DRAWN BY RBV	SCALE NTS	SHEET 1 of 1	SIZE A
-------------------	-----------------	--------------	-----------------	-----------

NOTE: THIS DRAWING EMBODIES A CONFIDENTIAL PROPRIETY DESIGN ORIGINATED AND OWNED BY QUIKSERV CORP., AND IS SUBMITTED UNDER A CONFIDENTIAL RELATIONS ALL PATENT, MANUFACTURING, SALE RIGHTS REGARDING THE SAME ARE RESERVED EXCEPT TO THE EXTENT RIGHTS ARE EXPRESSLY GRANTED TO OTHERS. THE RECIPIENT AGREES BY ACCEPTING HIP. THESE DRAWINGS NOT TO SUPPLY OR DISCLOSE ANY INFORMATION REGARDING THEM TO ANY UNAUTHORIZED PERSON.