

LEFT SIDE VIEW

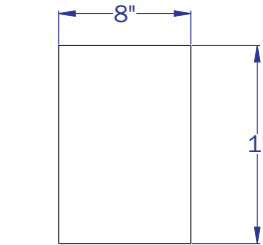

FOOT PRINT

EXTERIOR
ROUGH OPENING
4" X 9"

WALL
DEPTH

EDU HEAD & CHUTE CAN
BEAR THE WEIGHT OF
RECEIVING CHEST
ALLOWING CHEST TO
SUSPEND ON INTERIOR
WALL.

WALL DEPTH
ELEVATIONS
ARE PROVIDED FOR
MINIMUM CLEARANCE
PURPOSES ONLY.

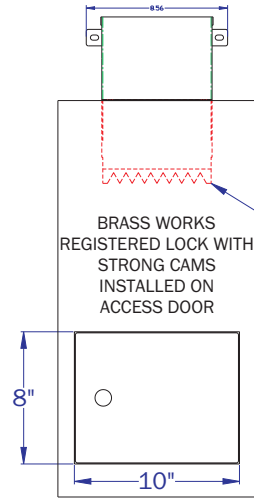

INTERIOR VIEW

MODEL EDU
INCLUDES

PART ID	DESCRIPTION
0109	LOCKED CHEST, SS HEAD, DELIVERY CHUTE, LOCK AND KEYS, SIGNS: "ENVELOPE DEPOSITORY" OR "PAYMENT DROP" & "LIFT TO DEPOSIT"

ACCESSORY OPTIONS

PART ID	DESCRIPTION
0110	LARGE RECEIVING CHEST 36" HIGH CHEST FOR 300+ PAYMENTS (REPLACES 24" CHEST)
0608	LOCKABLE LIFT PLATE INCLUDES LOCK BAR, PAD LOCK, AND 2 KEYS
0711	WIDE-SLOT SS HEAD 2" X 6.5" SLOT OPENING (REPLACES 5/8" OPENING)
0801	ENVELOPE HOLDER 8" X 4.5" INCHES WIDE [25 CAPACITY]
0802	ENVELOPE HOLDER 10.5" X 4.5" INCHES WIDE [25 CAPACITY]
0803	EXTRA ENVELOPE HOLDER 10.5" X 4.5" INCHES WIDE [100 CAPACITY]
0805	ENVELOPE HOLDER W/ WRITING SHELF 11" X 9.75" X 6" BLACK SIGN ON LIFT PLATE READS "ENVELOPES" [50 CAPACITY]

SS HEAD &
STEEL DELIVERY CHUTE DETAIL

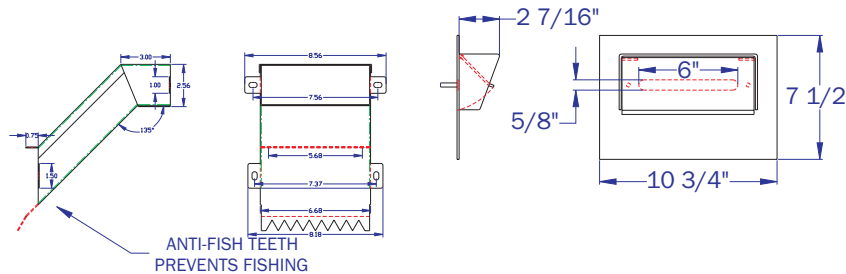

WALL DEPTH ELEVATIONS

ASSUMES SAME
INTERIOR AND EXTERIOR GRADE

WALL DEPTH	MINIMUM CENTER LINE OF ROUGH OPENING	
	24" CHEST	36" CHEST
0"	21 5/8"	33 5/8"
2"	22 5/8"	34 5/8"
4"	23 5/8"	35 5/8"
6"	25 5/8"	37 5/8"
8"	27 5/8"	39 5/8"
10"	29 5/8"	41 5/8"
12"	31 5/8"	43 5/8"
14"	33 5/8"	45 5/8"
16"	35 5/8"	47 5/8"
18"	37 5/8"	49 5/8"
20"	39 5/8"	51 5/8"



COVENANT
Security Equipment

TITLE
EDU_CUT SHEET

PART NAME
MODEL EDU

REV	DESCRIPTION	DATE	BY	TOL: UNLESS OTHERWISE SPECIFIED ANGLES: ±1° .XX±.030 .XXX±.010
	RELEASE	09-01-10	JRS	

SHEET	PART ID #	SCALE	REV
	0109	NTS	