

CSE-QS-SS-CA-4035E LEFT

Top View

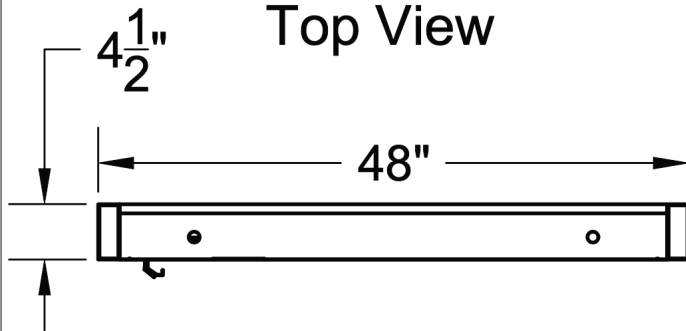

Interior View

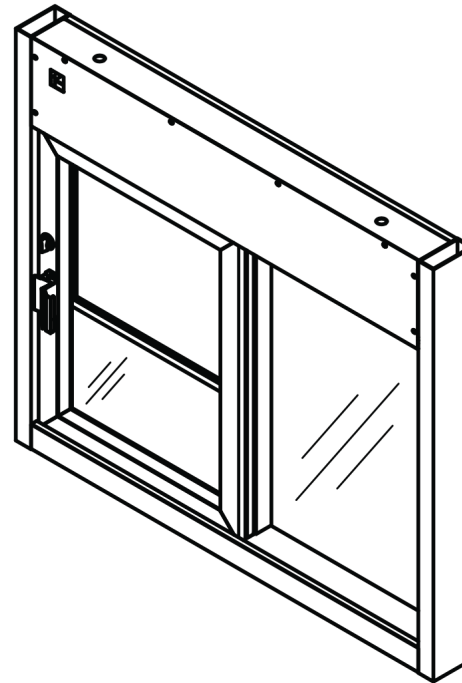
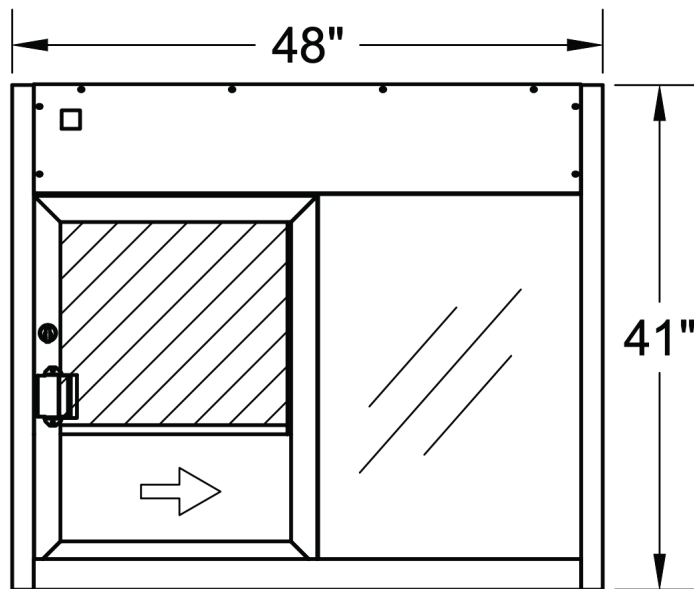

Side View

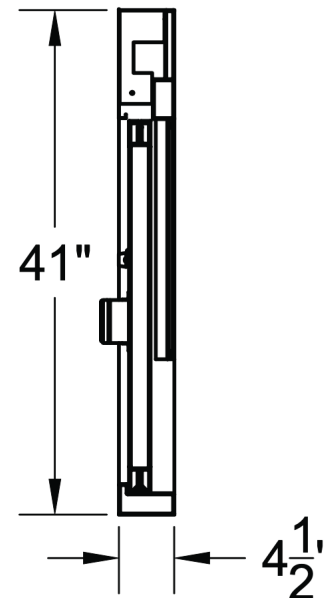

COVENANT
Security Equipment

www.covenantsecurityequipment.com

PLEASE SELECT:

1. FRAMING:

☐ Aluminum ☐ Loaded Frame

2. FRAME COLOR:

☐ Bronze Anodized ☐ Clear Anodized

Other: _____

3. GLAZING:

☐ 1/4" Tempered ☐ 5/8" or 1" Insulated

☐ 3/4" Poly - L1 ☐ 1-1/4" Acrylic - L1

☐ 1-1/4" Poly - L3 ☐ 1-1/4" Acrylic - L3

☐ 7/8" Storm Impact

Other: _____

Key Notes

Unit:

CSE-QS-SS-CA-4030 LEFT

Actual Dimension:

48"(W) X 41"(H)

Rough Opening:

48 3/8"(W) X 41 3/8"(H)

Service Opening:

20 1/4"(W) X 10 7/8"(H)

CALI OPENING 216 SQ IN

Engineer Notes

Date drawn:12/19/2019

Drawn by:A.V.

File name:SS-4035E CALI 216

Page: 1 OF 1

Scale: 1:16

NOTE: THIS DRAWING EMBODIES A CONFIDENTIAL, PROPRIETARY DESIGN ORIGINATED AND OWNED BY COVENANT SECURITY EQUIPMENT, AND IS SUBMITTED UNDER A CONFIDENTIAL RELATIONS ALL PATENT, MANUFACTURING, SALE RIGHTS REGARDING THE SAME ARE RESERVED EXCEPT TO THE EXTENT RIGHTS ARE EXPRESSLY GRANTED TO OTHERS. THE RECIPIENT AGREES BY ACCEPTING THESE DRAWINGS NOT TO SUPPLY OR DISCLOSE ANY INFORMATION REGARDING THEM TO ANY UNAUTHORIZED PERSONAL.

SIGNATURE: _____

DATE: _____

CSE-QS-SS-CA-4035E RIGHT

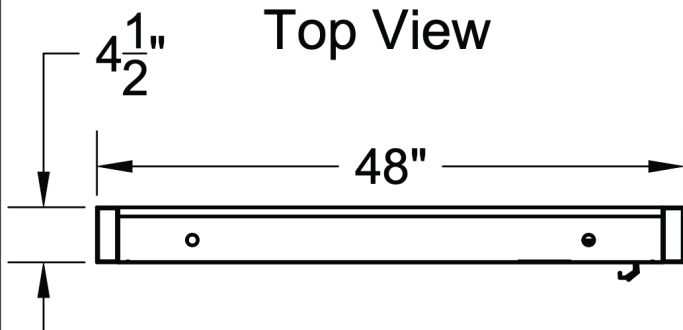

Interior View

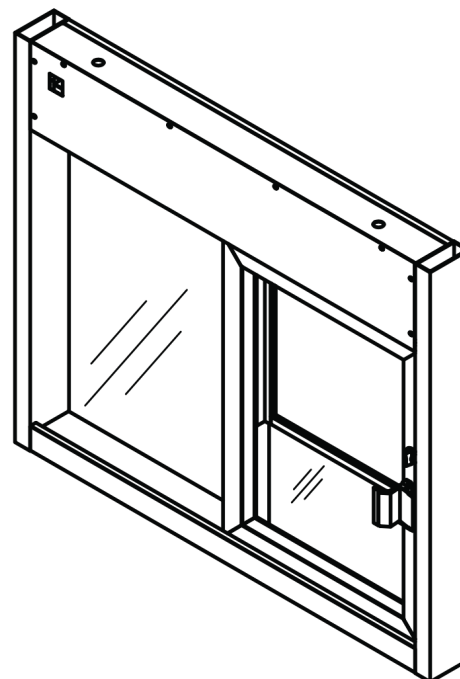
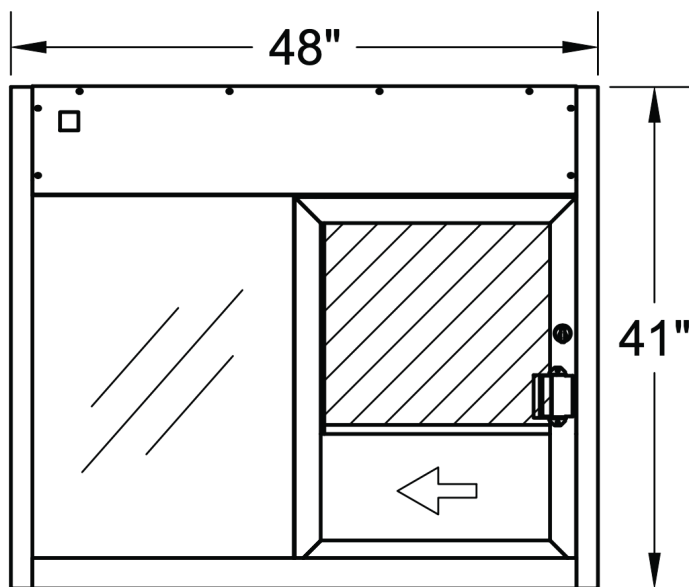

Side View

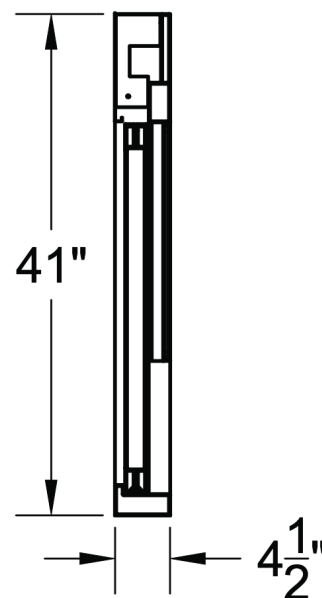

COVENANT
Security Equipment

www.covenantsecurityequipment.com

PLEASE SELECT:

1. FRAMING:

☐ Aluminum ☐ UL Rated Alum

2. FRAME COLOR:

☐ Bronze Anodized ☐ Clear Anodized

Other: _____

3. GLAZING:

☐ 1/4" Tempered ☐ 5/8" or 1" Insulated

☐ 3/4" Poly - L1 ☐ 1-1/4" Acrylic - L1

☐ 1-1/4" Poly - L3 ☐ 1-1/4" Acrylic - L3

☐ 7/8" Storm Impact

Other: _____

Key Notes

Unit:

CSE-QS-SS-CA-4030 RIGHT

Actual Dimension:

48"(W) X 41"(H)

Rough Opening:

48 3/8"(W) X 41 3/8"(H)

Service Opening:

20 1/4"(W) X 10 7/8"(H)

CALI OPENING 216 SQ IN

Engineer Notes

Date drawn: 12/19/2019

Drawn by: A.V.

File name: SS-4035E CALI 216

Page: 1 OF 1

Scale: 1:16

NOTE: THIS DRAWING EMBODIES A CONFIDENTIAL PROPRIETY DESIGN ORIGINATED AND OWNED BY COVENANT SECURITY EQUIPMENT, AND IS SUBMITTED UNDER A CONFIDENTIAL RELATIONS ALL PATENT, MANUFACTURING, SALE RIGHTS REGARDING THE SAME ARE RESERVED EXCEPT TO THE EXTENT RIGHTS ARE EXPRESSLY GRANTED TO OTHERS. THE RECIPIENT AGREES BY ACCEPTING THESE DRAWINGS NOT TO SUPPLY OR DISCLOSE ANY INFORMATION REGARDING THEM TO ANY UNAUTHORIZED PERSONAL.

SIGNATURE: _____

DATE: _____